

BRINGING ALL THE RIGHT THINGS TOGETHER

ENVIROPROBE

INTEGRATED SOLUTIONS, INC.

DRILLING ♦ ENGINEERING ♦ ENVIRONMENTAL PROFESSIONALS

SERVICE BRIEF

*GIS – Mapping and Analysis Information System
Implementation and Design
Environmental and Geotechnical Drilling*

GIS – Mapping and Analysis

EnviroProbe Integrated Solutions, Inc (EnviroProbe) is a woman-owned small business located in Nitro, West Virginia. EnviroProbe's team of GIS professionals has performed GIS mapping, geospatial analysis and designed and implemented GIS for several institutions.

Geographic Information Systems (GIS) revolutionize the way we analyze and understand information. By integrating location-based data into areas such as asset management, energy reserves, transportation systems and even customer demographics, organizations visualize events in powerful new ways - finding new efficiency, productivity, and profitability.

EnviroProbe understands the GIS requirements of both large and small organizations, private and public alike. From detailed assessments to final deliverables, EnviroProbe will help your organization reach its goals in the GIS market. EnviroProbe uses GIS to incorporate and analyze many types of information and images for site analysis. Highly accurate results displayed geographically provide insight into connections and relationships, and customers relate easily to a recognizable map.

The team at EnviroProbe has been using GIS for more than 15 years, in a variety of industries. The team (EnviroProbe) has utilized GIS in the cultural resources, mining, oil and gas, cellular, wind, and land development industries to delineate, map, and gather important tracking and management information for multiple projects. EnviroProbe has used GIS as an integral process of site assessment and site remediation.

GEOGRAPHICAL INFORMATION SYSTEM (GIS) SERVICES

- Spatial Analysis
- 3D Modeling
- Groundwater Remediation:
- Site Assessment
- Project management
- Remediation Planning/Implementation
- Land Owner Tract Information
- Reclamation Planning
- Agricultural Resource Planning
- Viewshed Analysis
- Asset Management / Cataloging
- Regional Planning
- Database design and Implementation

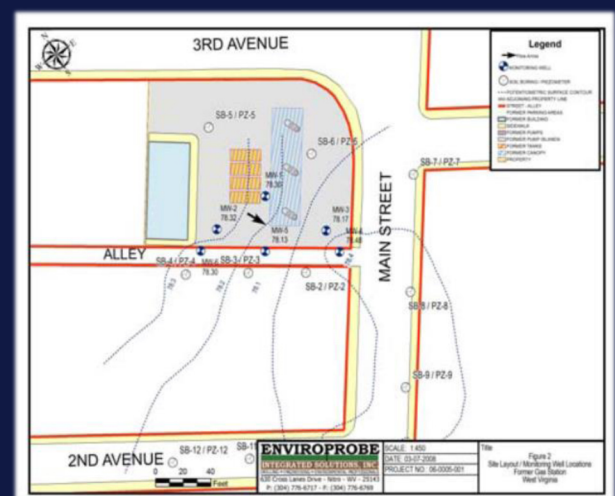

PEC Premiere ♦ PICS Auditing ♦ ISNetworld ♦ WV OM&GA ♦ WV IOGA ♦ WVONGA

www.enviroprobeinc.com

Headquarters 304.776.6717 ♦ Morgantown Office 304.381.4460

BRINGING ALL THE RIGHT THINGS TOGETHER



SERVICE BRIEF

*GIS – Mapping and Analysis Information System
Implementation and Design
Environmental and Geotechnical Drilling*

GIS – Mapping and Analysis

HYDROGEOLOGIC MODELING

Proper characterization of the hydrologic conditions at a site is necessary in order to understand the importance of relevant flow or solute-transport processes. We have conducted numerous groundwater studies to determine the nature and extent of aquifer contamination and to delineate plume boundaries.

- GMS 6.5 (MODFLOW2000 & MODPATH)
- Confined / Unconfined Aquifers
- Regional-Scale Models
- Local-Scale Models
- Multiple Aquifers
- Groundwater Resources and Modeling
- Delineate plume boundaries
- Capture Zone Analysis
- One, two and three-dimensional models

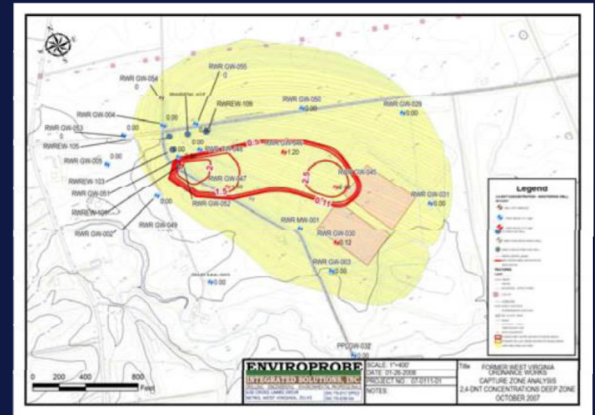

GEOLOGICAL MODELING SERVICES

- Slope Analysis
- Reserve Evaluation
- Detailed Geological Maps and Cross Section Graphics
- Detailed Coal Quality Modeling
- Detailed Burden Characterization and Modeling
- Mine Evaluation and Hazard Prediction
- GIS Based Database and Property Management

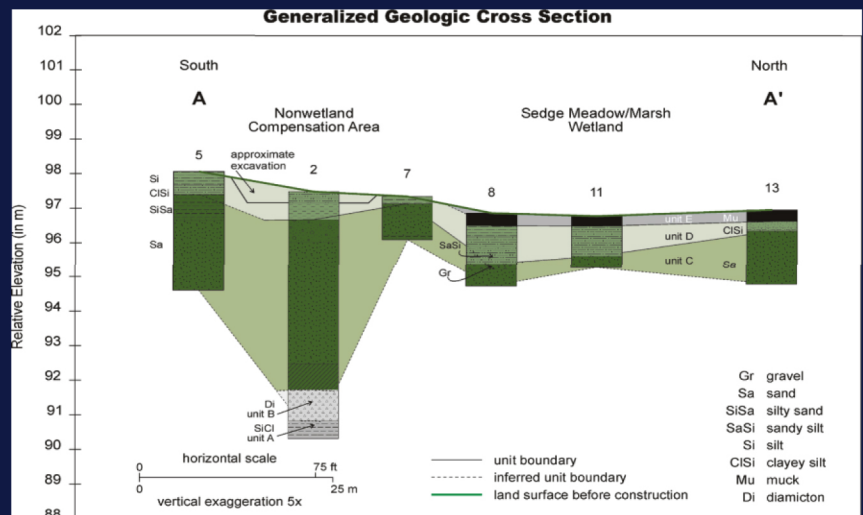

PEC Premiere ♦ PICS Auditing ♦ ISNetworld ♦ WV OM&GA ♦ WV IOGA ♦ WVONGA

www.enviroprobeinc.com

Headquarters 304.776.6717 ♦ Morgantown Office 304.381.4460